

Retired Members of Local Union #134, I.B.E.W.

Retiree's Newsletter

DECEMBER



2015

Newsletter of the Retired Members of Local Union number 134, I.B.E.W. - Send all correspondence to Retiree's Club, 600 W. Washington Blvd., Chicago, IL 60661-2490 - The Club meets on the second Wednesday of each month except March, June, September and December at the Apprentice School 115th and Ridgeland Alsip IL. The purpose of this organization shall be to carry out the spirit of brotherhood, to aid and assist each other, and to further education, economic health and welfare of its members and their families and electrical apprentices. www.Local134chicago.com Written & Edited by Mario Coletta Mailed by Bernie Martin

FROM THE PODIUM

Solar and Wind at the Apprentice School

The Renewable Energy Training Field (RETF) features an 85-foot tall, 5 kW wind turbine that students can use to understand how to operate, inspect and maintain turbines out in the field. The turbine's streamlined housing can be hydraulically raised and lowered for either maintenance needs or to show students the different housing components of a wind turbine.

Also on the site are a 60-foot tall, enclosed tower that mimics the base of a wind turbine and a 100-foot tall cell tower. Scaling such towers in the field can be both physically demanding and treacherous so students will learn not only how to safely ascend such a structure, but how to rescue and lower a worker who has been injured.

The IBEW NECA Technical Institute (IN-TECH) has a new facility that contains solar photovoltaic panels in a number of environments and installations that electricians might encounter on the job. A 3 kW dual-axis tracker, for example, follows the sun on its daily path, harvesting up to 40% more energy than a fixed-angle array.

While fixed panels aren't as efficient as tracking versions, they are cheaper and thus, more commonly installed.

The RETF features a 45 kW ground-mounted solar array that mimics what the students might find in a utility application. The rugged mechanical support structure is designed for repeat installation and take-down scenarios. A separate 18 kW solar carport has five electric car charging stations, built to adapt to the evolution of electric vehicle technology.

The Retirees Club thanks Andy Gerk for his presentation.

CALENDAR

Nov 11- Regular Meeting 1:00 pm
Apprentice School 115th and
Ridgeland Alsip IL Free Turkey
Raffle. Come at noon for the greet
and meet.

Nov 19- Drury Lane Play
White Christmas the Musical
Luncheon served at 11:30 am.

Nov 30- E-Board Meeting 10:30 am

Dec 9- Holiday Party at the Irish
American Heritage Center noon.

Dec 14- E- Board Meeting 10:30 am

Dec 25- Merry Christmas.

DUES RENEWAL NOTICE

Please look at your Retired Members of Local 134 membership card, if it does not say 2016 or 2017 your dues are due. You can pay your 2016 dues by filling in the form below and sending it with a check for \$20.00 made payable to the Retired Members of Local 134. To the treasurer Bernard Martin at 8706 N. Olcott Ave. Niles, IL. 60714

Here are my 2016 dues of \$20.00

PLEASE PRINT

Name _____

Spouse _____

Address _____

City _____ State _____ Zip _____

Telephone (____) _____

Cell Phone (____) _____

E-Mail _____

Please include all information so that we can double-check our records for the next mailing.

Make checks payable to the order of: Retired Members of Local # 134, IBEW and mail to Bernard Martin, 8706 N. Olcott Ave Niles, IL. 60714

If you have a second address where you spend time for several months, please let us know that address and the weeks or months on a separate sheet of paper so that we can send the Newsletter to that place when you are there.

NOTE: Widows of deceased members of the Retires Members of Local 134 IBEW club are associate members of the club and DO NOT PAY DUES.

Drury Lane Dinner Theatre Presents:

IRVING BERLIN'S **White Christmas** THE MUSICAL

Our next play will be held on Thursday November 19th 2015 and lunch will be served at 11:30 a.m. Show to follow 1:30 pm at the Drury Lane Playhouse in Oak Brook Terrace. Your ticket order must be in Walter Felde's hands by November 1st, 2015 with your check for \$49.00 per person. Make checks payable to: Retired Members of Local #134, IBEW. Walter Felde will have your tickets at Drury Lane at the Matradee's podium. Tickets will not be mailed to you.

The Meal:

First Course: Soup of the Day
Chef Choice

Entrees:

Pecan Crusted Tilapia _____ **Or**

Creamy Roasted Garlic Butter Sauce

Traditional Roast Turkey _____

Sliced Breast/ Herb Stuffing/ Cranberry Sauce/ Turkey Gravy

All Entrees served with dinner rolls, choice of one non alcoholic beverage and chef's selection of potato, vegetable and desert.

Name _____

Guest _____

Send your order to:

Walter Felde
6543 N Oshkosh
Chicago IL 60631

Based on the beloved, timeless film, this heartwarming musical adaptation features seventeen Irving Berlin songs.

Veterans Bob Wallace and Phil Davis have a successful song-and -dance act after World War II. With romance in mind, the two follow a duo of beautiful singing sisters en route to their Christmas show at a Vermont lodge, which just happens to be owned by Bob and Phil's former army commander. The dazzling score features well known standards including Blue Skies, I Love A Piano, How Deep Is The Ocean and the perennial favorite, White Christmas.

100 Drury Lane* Oakbrook Terrace, IL 60181

2015 GOLF OUTTING

Our Annual John Cummins Golf Outing was September 16th at the Old Oaks Golf Course, Homer Glen, IL.

The weather was absolutely perfect for our 31 golfers.

We started the morning at 8 AM with coffee and a muffin. Each golfer was given 3 golf balls, a bottle or can drink insulator and a small utility bag donated by GWC (Goldberg Weisman Cairo Law Firm)

We teed off at 9:00 AM and finished about 1:30 PM, lunch was served in the clubhouse at 2:00.

After lunch we awarded \$20 to Fran Jackson and \$20 to Carl Si for closest to the pin drive on the 4th and 16th holes.

Everyone had a great time and look forward to next year.

We thank Local 134 IBEW for a donation of \$ 250.00.

We thank Retired Members of Local 134 for a donation of \$ 250.00

We thank Horwitz, Horwitz & Associates for donating a 32" High Definition Television.

Lastly, we held the door prize drawing.

Door prize winners:

Terry Rietz 32" HD television

Thomas Boyle \$ 100

John McNulty \$ 50

Don Bates \$ 50

Jim Fliris \$ 50

Mike Connaughton \$ 50

Fran Jackson \$ 50

Phil Costello \$ 50

Kevin Gibbons \$20

Terry Harmon \$ 20

Paul LaPato \$ 20

The Retirees Club extends our thanks to E Board member Kevin Gibbons for all he and E Board member Jim Fliris have done to make this annual outing a success.

THE RETIRED MEMBERS OF LOCAL UNION #134 IBEW INVITE YOU TO OUR
ANNUAL HOLIDAY PARTY
AT THE IRISH AMERICAN HERITAGE CENTER
4626 NORTH KNOX AVE.
WILSON AND KNOX, CHICAGO
AT NOON, DECEMBER 9, 2015

FOR CORNED BEEF DINNER _____

OR ROAST CHICKEN DINNER _____

BOTH MEALS WITH BOILED POTATOES, CABBAGE AND BEER

PIE FOR DESERT WITH COFFEE OR TEA

THERE WILL BE A CASH BAR

NAME _____

GUEST _____

The cost for members and their wives is \$32.50 per person
Widows of our deceased members are free. Widows are asked to send in their
reservation. Mail this reservation form to: Richard Sipple
901 Pheasant Walk
Schaumburg IL 60193

Make checks payable to the order of Retired Members of Local Union #134 IBEW
Please allow enough time to mail your payment. We must know the total number of
guests by December 2nd.

RECIPE EXCHANGE

You may have seen this recipe in the paper recently but I tried it and found it to be worth passing on.

WHITE CHICKEN CHILI

2 cans (15.5) Bush's White Chili Beans undrained

1 can (10oz) diced tomatoes and green chilies undrained

Chicken from a roasted chicken

1 can (14oz) reduced sodium Chicken Broth

1 can (10.5oz) cream of chicken soup

1-2 jalapeno peppers seeded and diced

Mash ½ can of beans and put in pot. Add all the other ingredients and bring to a boil. Reduced heat and simmer for about 20 minutes. You can serve with toppings of sour cream, Mexican cheese, tortilla strips etc.

I must confess I purchased my beans, broth, soup, and diced tomatoes and green chilies from Aldi, therefore they were not a name brand. I also cooked 2 large Chicken breasts and used them instead of the roasted chicken. Also, to seed the jalapeno peppers I take a plastic sleeve that the newspaper is delivered in, and put one sleeve on each hand. This avoids fingers from every touching the seeds which could be harmful to your skin.

Because I read this joke and enjoyed it, I am passing it on to you.

A WIFE INVITED SOME PEOPLE TO DINNER. AT THE TABLE, SHE TURNED TO HER 6 YEAR OLD DAUGHTER AND SAID. "WOULD YOU LIKE TO SAY THE BLESSING?" "I WOULDN'T KNOW WHAT TO SAY," THE GIRL REPLIED. "JUST SAY WHAT YOU HEAR MOMMY SAY," THE MOTHER ANSWERED. THE DAUGHTER BOWED HER HEAD AND SAID, "LORD WHY ON EARTH DID I INVITE ALL THESE PEOPLE TO DINNER?"

NOVEMBER 19th

Just a reminder, we are going to lunch and to see White Christmas at the Drury Lane Playhouse.

DECEMBER 9th

We will be at the Irish Heritage Center for our annual Holiday Party. If you have not signed up yet, please send your reservation in ASAP to Rich Sipple. We have a reservation sheet attached to this newsletter. **Corned beef, cabbage, potatoes, pie and beer.** It makes your mouth water thinking about it.

A reminder to all retirees: We'll be getting our annual life insurance billing. This is the premium for the new \$10,000 policy. Don't forget!

IF YOU ARE ARRIVING BY BUS:

*Give this map to your driver to aid in directions.

*BUS DRIVERS...You may pull under the canopy to unload and load but PLEASE TURN OFF YOUR ENGINE WHILE UNDER THE CANOPY.

IF YOU ARE ARRIVING BY CAR:

*Please copy this map and distribute to your guests.

*Free parking is available surrounding Drury Lane and Hilton Suites.

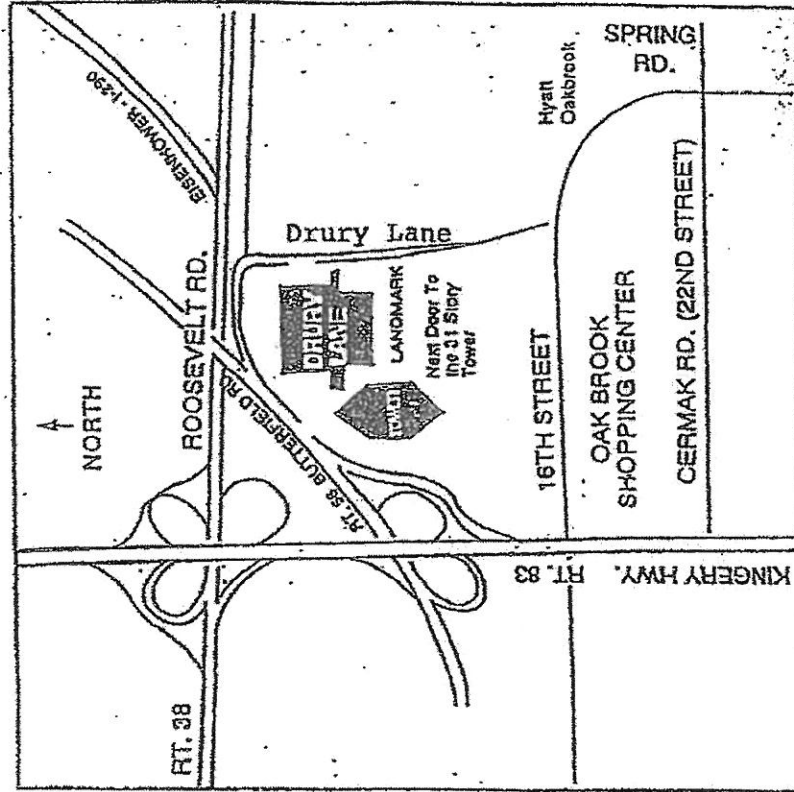

WHEN APPROACHING FROM THE NORTH OR SOUTH ON ROUTE 38: Exit at Roosevelt/Butterfield Road East (Roosevelt Road is Route 38). Follow the GREEN sign to DRURY LANE.

WHEN APPROACHING FROM THE EAST OR WEST ON ROOSEVELT ROAD: Exit Route 83 (Kingery Hwy.) South to Roosevelt Road (Route 38) East and follow GREEN sign to DRURY LANE.

WHEN APPROACHING FROM DOWNTOWN CHICAGO: Take the Eisenhower Expressway (I-290) West to the East-West Tollway (I-88), Aurora exit. Immediately after paying the \$.40 toll at the Cermak Road/22nd Street tollbooth, exit Right and proceed North on Spring Road to DRURY LANE.

WHEN APPROACHING FROM THE WEST ON I-88: Exit at Midwest Road, turn Right, proceed North to Butterfield Road (Route 56). Turn right onto Butterfield Road, exit Roosevelt Road (Route 38) East to DRURY LANE.

WHEN APPROACHING FROM I-294 (IRL-STATE): to I-88 (East-West Tollway) West, to Aurora exit. Immediately after paying \$.40 toll at Cermak Road/22nd Street tollbooth, exit Right and proceed North on Spring Road to DRURY LANE.