

Retiree's Newsletter

SEPTEMBER



2015

Newsletter, of the Retired Members of Local union number 134, I.B.E.W. - Send all correspondence to Retiree's Club, 600 W. Washington Blvd., Chicago, IL 60661-2490 - The Club meets on the second Wednesday of each month except March, June, September and December at the Apprentice School 115th and Ridgeland Alsip IL. The purpose of this organization shall be to carry out the spirit of brotherhood, to aid and assist each other, and to further education, economic health and welfare of its members and their families and electrical apprentices. www.Local134chicago.com Written & Edited by Mario Coletta Mailed by Bernie Martin

CALENDAR

FROM THE PODIUM

On July 9th 2015, Denmark's wind farms were able to produce 116% of that nation's electricity needs. At 3 am the next day when electricity demand dropped that figure had risen to 140%. Interconnectors allowed 80% of the power surplus to be shared equally between Germany and Norway, which can store it in their hydropower systems for use later. Sweden took the remaining fifth of excess power.

"It shows that a world powered 100% by renewable energy is no fantasy," said Oliver Joy, a spokesman for the trade body European Wind Energy Association. "Wind energy and renewables can be a solution to decarbonisation – and also security of supply at times of high demand."

What ever happens in this country I know Local 134 will be in the forefront.

Mario Coletta

- Aug 12-** Regular Meeting 1:00 pm
Apprentice School 115th and
Ridgeland Alsip IL. Come at noon
for the greet and meet.
- Aug 31-** E-Board Meeting 10:30 am
- Sept 9-** Luncheon and Regular
Meeting noon at Boyle Auditorium
600 W Washington Blvd
- Sept 16-** Annual John Cummins
Memorial Golf Outing 8:00 am
- Sept 28-** E-Board Meeting 10:30 am
- Oct 14-** Regular meeting 1:00 pm
Apprentice School 115th and
Ridgeland Alsip IL. Come at noon
for the greet and meet.

IN MEMORIAM

Lionel C Bomar *James R Corbett
Ronald W Cullinan Nick V Fiore
*Daniel J Enright Mark W Forbes
William J Hinman Richard E Howe
Walter K Johnson Jr
Joseph L Kantutis Robert L Koehler
Edward N Koseck Frank Messina
James A McDonald Michael Panelli
Donald E Provance
Irwin I Rosnagle
Francis E Scheckel
Timothy J Schroll Gregory Shaffer
Edward M Vekemans

Our condolences to the families of
James R Corbett & Daniel J Enright

RETIRED MEMBERS OF LOCAL # 134 LUNCHEON

**SEPTEMBER 9TH 2015 AT BOYLE
AUDITORIUM 600 W WASHINGTON BLVD**

**OUR REGULARLY SCHEDULED DOLLAR LUNCHEON
WILL BE HELD AT NOON ON THAT DAY**

Name _____

Guest _____

Please print your name and guest's name

Make checks payable to: Retired Members of Local #134 IBEW
Send in Registration by September 1st

Mail this reservation form and your dollar per person to:

Bernie Martin
8706 N Olcott
Niles, IL 60714

Retired Members of Local #134 IBEW
Annual John Cummins Memorial Golf Outing
Wednesday, September 16, 2015



Old Oak Country Club "Golf Digest - 4 Stars"

14200 S. Parker Road
Homer Glen, IL 60491

****** Cost: \$65.00 ******

18 Holes of Golf with a cart for each golf team

Continental Breakfast at 8:00 AM
(Driving Range available prior to tee time)

Shotgun Start at 9:00 AM

Buffet Lunch and Prizes after Golf

Contact: Kevin Gibbons (630.877.7340)
117 Pepperwood Drive Bolingbrook, IL 60440
kgibbons101@comcast.net

RSVP by August 30, 2015

Mail advance payments / or due the morning of the golf outing.
Make checks payable to: The Retirees Club of Local 134 IBEW

July 8th 2015 Speaker

Retired 134 Business Representative Richard Murphy is now with the Federal Mediation & Conciliation Service (FMCS) as a Commissioner.

Rich, as usual, is very well versed in his *new* job and is very well educated to which he thanks his IBEW career. He is a 45 year member and retired last year. As a FMCS Commissioner he cannot use or refer to his past affiliation as a union member, due to he is *neutral* in his interactions.

Who is FMCS and how can they help? They were created by the Taft Hartley Act in 1947, neither to regulate nor enforce policy, but strictly to aid in the resolution of disputes between unions and employers. In some cases they do operate on a worldwide basis.

Their mission is to “bridge gaps” in collective bargaining, relationship development, grievance mediation, dispute resolution, outreach, and grants programs. These are all free of charge to the parties involved. The only requirement is **both** sides must ask for the help. This service has saved the economy by cutting work

stoppages from a high in 1948 of 1400 to 100 in 2008, and facilitating a much shorter duration in those actions today. This is done by clarify-ing issues, creating options to prob-lems, finding alternatives, keeping talks moving, offering suggestions and giving realistic expectations. The mediators are committed to con-fidentiality and will not even testify in court as to any discussions.

Grievance resolutions and dispute resolutions, I believe most of us are familiar with. The FMCS again will provide this when it is part of the collective bargaining agreement. This provides a **neutral** third party to aid both sides reach accord.

Outreach and Relationship Training are two programs that Rich was really excited about; this was something that had been foreign to us at the local. It allows both sides to train together and realize how working together beforehand and accepting the “group problem solving” dynamic is more productive than an adversarial one. The outreach program is what Rich gave us today, an oversight of the FMCS. They will also provide grant money to LMCC’s.

ARLINGTON PARK RACETRACK

AUGUST 20, 2015

We are going to the races on Thursday August 20th. If you are interested and want to join us, please complete the bottom portion of this flyer and return to me by August 10th.

Your fee of \$27.00 includes a **BOX SEAT, A RACING GUIDE AND A GRAB 'N GO LUNCH**. The GRAB 'N GO lunch is a choice of:

- **SMOKED PULLED CHICKEN SANDWICH** on an egg washed bun
- **BEER BRAISED BRATWURST SANDWICH** with caramelized onions and mustard on a sausage roll
- **BLACK BEAN BURGER SANDWICH** on a whole grain bun and assorted toppings

The sides include **KETTLE CHIPS, POTATO SALAD, SWEET AND SOUR COLE SLAW AND CHOCOLATE CHIP COOKIE**.

THE PARK OPENS AT 12 NOON

ARLINGTON SERVES THE GRAB 'N GO LUNCH FROM 12:30 UNTIL 2:30 PM
POST TIME 1:00 PM

I WILL TRY TO MAIL YOUR TICKETS TO YOU BY AUGUST 14TH

The parking is free or if you want you can take the metro to the park because there is a train station at the park. There is a fee if you want to use the valet parking. You can bring friends or relatives to this and any other event that we have outside of the meetings.

(cut and return bottom portion)

NAME _____

ADDRESS _____

CITY AND ZIP _____

NUMBER OF TICKETS _____ @ \$27.00 EACH

Send your check for \$27.00 per person made payable to the Retirees Club of Local 134, IBEW, to:
Gerry White, 237 W. Millers Rd., DesPlaines, IL 60016. For questions call me at 847-635-5659.

RECIPE EXCHANGE

TACO DIP

1 can refried beans

1 pkg. taco seasoning mix

½ cup mayonnaise

1 cup sour cream

shredded cheddar cheese

chopped tomatoes

sliced black olives

chopped green onions (optional)

Spread refried beans. Mix mayonnaise, sour cream and taco mix and layer over beans.

Top with tomatoes, olives, onions and shredded cheese.

This recipe is old but I just came across it and thought you might want to have it rather than buying it at the store ready made. At least you know it is fresh and can be made cheaper than what it cost at the store.

AUGUST 12th

Our meeting will be held at the Apprentice School in Alsip. Michael Betar will be our guest speaker to talk about his organization. The Veterans' History Project documents the veterans' experiences while they were serving in the military.

AUGUST 20th

We are having an outing at the Arlington Racetrack in Arlington Heights. The cost is \$27.00 and includes lunch, racing form and a box seat. If you have never been it is a nice

outing and there is always a nice breeze. Sign up sheets are attached.

SEPTEMBER 2nd

We are going to see the Schaumburg Boomers play the Washington Wild Things at the Boomers Stadium in Schaumburg. It is easy to get to from all directions. Game starts at 1:00 pm. Cost is \$9.00 per ticket. Sign up sheets are attached.

SEPTEMBER 9th

This meeting will be at the Union Hall. It is a luncheon meeting which starts at 12:00 pm. Sign up sheets are attached. Our speaker that day will be a representative from Mayflower Tours. She will be explaining to us about the Value Tour that we would like you to take with the Retirees' Club. It is an 8 day trip planned for next April 17th. It does not mean that you have to sit and do everything with the club; it means we will all be traveling together.

SEPTEMBER 16th

You still have time to sign up for the JOHN CUMMINS MEMORIAL golf outing to be held at the Old Oak Country Club. See the attached sign up sheet.

OCTOBER 21st

It was suggested that we should go out to Cantigny Park. I have booked a date of October 21st and will let you know details later.

Drury Lane Dinner Theatre Presents:

IRVING BERLIN'S **White Christmas** THE MUSICAL

Our next play will be held on Thursday November 19th 2015 and lunch will be served at 11:30 a.m. Show to follow 1:30 pm at the Drury Lane Playhouse in Oak Brook Terrace. Your ticket order must be in Walter Felde's hands by November 1st, 2015 with your check for \$49.00 per person. Make checks payable to: Retired Members of Local #134, IBEW. Walter Felde will have your tickets at Drury Lane at the Matradee's podium. Tickets will not be mailed to you.

The Meal:

First Course: Soup of the Day
Chef's Choice

Entrees:

Pecan Crusted Tilapia _____ **Or**
Creamy Roasted Garlic Butter Sauce
Traditional Roast Turkey _____
Sliced Breast/ Herb Stuffing/ Cranberry Sauce/ Turkey Gravy

All Entrees served with dinner rolls, choice of one non alcoholic beverage and chef's selection of potato, vegetable and desert.

Name _____

Guest _____

Send your order to:

Walter Felde
6543 N Oshkosh
Chicago IL 60631

Based on the beloved, timeless film, this heartwarming musical adaptation features seventeen Irving Berlin songs.

Veterans Bob Wallace and Phil Davis have a successful song-and -dance act after World War II. With romance in mind, the two follow a duo of beautiful singing sisters en route to their Christmas show at a Vermont lodge, which just happens to be owned by Bob and Phil's former army commander. The dazzling score features well known standards including Blue Skies, I Love A Piano, How Deep Is The Ocean and the perennial favorite, White Christmas.

100 Drury Lane* Oakbrook Terrace, IL 60181

SCHAUMBURG BOOMERS BASEBALL

SEPTEMBER 2, 2015

EVENT: SCHAUMBURG BOOMERS vs WASHINGTON WILD THINGS

TIME: 1:00 PM

COST: \$9.00 PER TICKET

The park opens at 10:00 AM, so you can plan on coming early to look around, have your lunch or get a better parking stop in the free parking lot. I make NO plans for a special lunch but there should be plenty of food at the park. They have the usual baseball park food, and the kids will be back in school I hope.

You can invite someone who is not a member of the Retirees Club to this event and please ask your spouse.

If you could send in your check and the bottom portion of this sheet before August 17th, I will be able to mail your tickets in time for the game date.

(cut and return bottom portion of this sheet)

NAME _____

ADDRESS _____

CITY AND ZIP _____

NUMBER OF TICKETS _____ @ \$9.00 EACH

Send your check for \$9.00 per person made payable to the Retirees Club of Local 134, IBEW, to:
Gerry White, 237 W. Millers Rd., DesPlaines, IL 60016. For questions call me at 847-635-5659.

If you are arriving by bus:

*Give this map to your driver to aid in directions.

*BUS DRIVERS...You may pull under the canopy to unload and load but PLEASE TURN OFF YOUR ENGINE WHILE UNDER THE CANOPY.

If you are arriving by car:

*Please copy this map and distribute to your guests.

*Free parking is available surrounding Drury Lane and Hilton Suites.

WHEN APPROACHING FROM THE NORTH OR SOUTH ON ROUTE 88: Exit at Roosevelt/Butterfield Road East (Roosevelt Road is Route 38). Follow the GREEN sign to DRURY LANE.

WHEN APPROACHING FROM THE EAST OR WEST ON ROOSEVELT ROAD: Exit Route 83 (Kingery Hwy.) South to Roosevelt Road (Route 38) East and follow GREEN sign to DRURY LANE.

WHEN APPROACHING FROM DOWNTOWN CHICAGO: Take the Eisenhower Expressway (I-290) West to the East-West Tollway (I-88), Aurora exit. Immediately after paying the \$.40 toll at the Cermak Road/22nd Street tollbooth, exit Right and proceed North on Spring Road to DRURY LANE.

WHEN APPROACHING FROM THE WEST ON I-88: Exit at Midwest Road, turn Right, proceed North to Butterfield Road (Route 56). Turn right onto Butterfield Road, exit Roosevelt Road (Route 38) East to DRURY LANE.

WHEN APPROACHING FROM I-294 (TRI-STATE): to I-88 (East-West Tollway) West, to Aurora exit. Immediately after paying \$.40 toll at Cermak Road/22nd Street tollbooth, exit Right and proceed North on Spring Road to DRURY LANE.

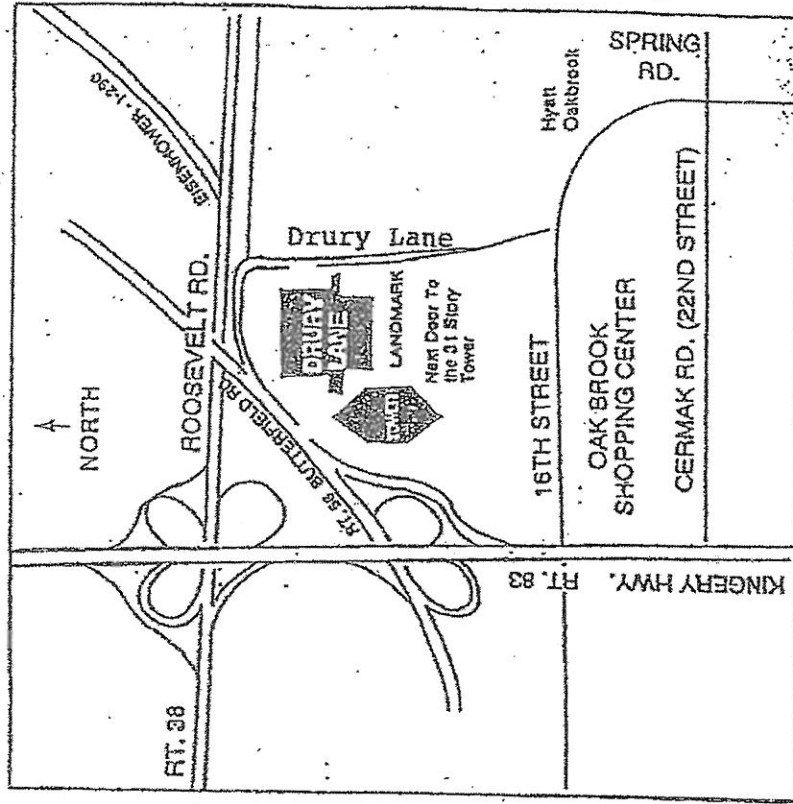

I-88

Cermak
Exit